

30 Kg CO₂ Mobile Fire Extinguisher

- Robust
- For professional use in harsh environments

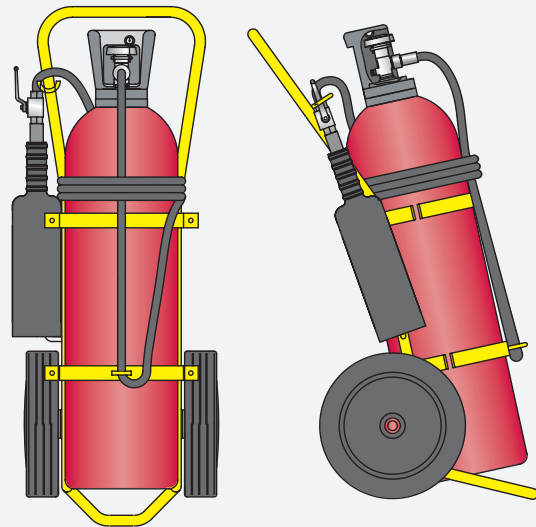

A high quality and robust mobile 30 Kg CO₂ gas extinguisher for professional use in harsh environments

Extinguishing medium

CO₂ gas
99% pure
Moisture less

Filled weight

Northern climates: 75% volume, 30 Kg
Tropical climates: 66% volume, 27 Kg

CO₂ cylinder

267mm Ø
Cold drawn steel 34Cr Mo4
Test pressure (hydraulic) >=250 bar
TPED approved

Cylinder valve

Material: Brass (to EN12420)
3/4" handwheel
Safety valve set to 235 +/- 15 bar

Painting

Epoxy-polyester powder
Resistant to ultraviolet
Cylinders Red to RAL 3000
Frame Red

Discharge hose

5m long x 3/8" SAE 100 R1 AT
Discharge horn with insulated handle
Quarter turn operating valve

Frame

Welded steel "wrap around" frame
300mm Ø rubber rimmed wheels

Labelling



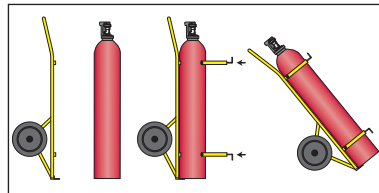

English/Arabic or English only

Corrosion often occurs where the support frame is welded to the cylinder causing it to be unsafe. Angus Fire mobiles use a wrap around frame to support the cylinder. During maintenance the frame can be removed for servicing or repair.

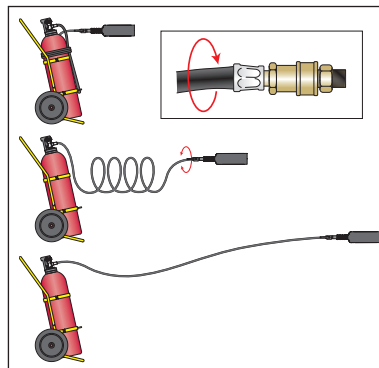

A swivel is fitted as standard on all Angus Fire mobiles between the discharge hose and the nozzle. When the coiled hose is unwound the hose can un-twist leaving the nozzle free to direct the jet.

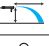

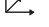
	Inflammable liquids, gasoline, oil etc.
	Temperature range: -30°C to +60°C Operating pressure: 60 bar @ 20°C nominal
	Jet length: ~ 5m Discharge time: ~ 27.5 seconds
	Filled weight: 85 Kg Packed volume: 0.4 cum
	Width: 500mm Depth: 700mm Height: 1200mm

Options:

Dust cover
Extra length discharge hose 10m, 15m or 20m
Rigid 2m helicopter lance
Marine paint finish (minimum quantities)
MED Approval 

The full range of Angus mobile extinguishers includes:
50 l; 100 l AFFF Foam
50 kg; 75 kg; 100 kg ABC powder
35 kg; 50 kg; 70 kg Monnex™ powder
10 kg; 20 kg; 30 kg; 50 kg CO₂

UK SALES

Angus Fire Ltd
Station Road, Bentham, Lancaster, LA2 7NA, UK
Tel: +44 (0)1524 264000 • Fax: +44 (0)1524 264180