

Hand Monitor MM1

- Exceptional operational reliability
- Long life and maintenance free



The MM1 is a lightweight and cost-effective manual monitor, designed for use at operating pressures between 5 and 15 bar g.

Fabricated in corrosion resistant gunmetal this monitor is ideally suited to water cooling and both aspirated and non-aspirated foam applications, when fitted with a suitable water nozzle, or foam cannon.

The single 75mm (3") waterway-design is capable of maximum flows up to 4500 litres/min and built-in flow straighteners provide optimum hydraulic efficiency.

The monitor is capable of full 360° rotation with generous elevational movement covering 85° above and 50° below horizontal. Separate friction locks will maintain the monitor position, once set for prolonged unattended operation.

Smooth movement is provided by a double row of bearings at each rotating joint with precise adjustment controlled by a stainless steel positioning handle.

Recommended for use with Angus LTN or High Combat Monitor nozzles and cannons, see separate data sheets for details.

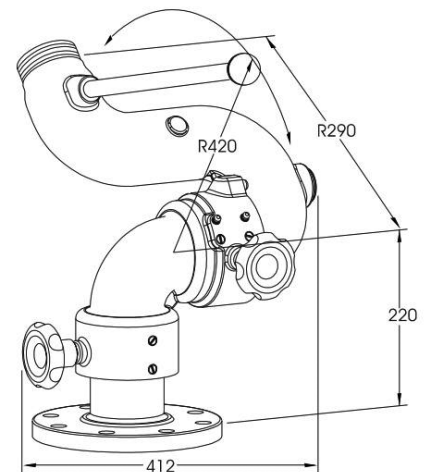

Dimensions in mm.

Specification	
Operating pressure	Min: 5 bar g (70psi), Max: 15 bar g (215psi)
Test pressure	22.5 bar g (325psi)
Maximum flow	4,500 litres/min
Inlet flange connection	4" ANSI Class 150 FF (alternatives to special order)
Outlet connections	2½" BSP Male (alternatives to special order)
Monitor Body	Gunmetal LG2 to BS EN 1982
Bearings	316 Stainless Steel
Approx. weight (without nozzle/cannon)	33 kg